



Date: Fri April 29 - Sun May 1 2022 **Time:** Fri 9am to Sun 6pm

Comments:

TMP # 2022039
 Client : Uniting Church Queenscliff
 Project: Sacrededge Festival
 Location: Stokes St Queenscliff
 Melways: 486:J12

Notes

Safety buffers or clear zones of at least 20 m (<60 km/h) to 30 m (>60 km/h) will be maintained prior to the work zone at all times

Bollard spacing:
 in tapers shall be 10% of the speed limit expressed in meters.
 to delineate the work zone shall be 10% of the speed limit expressed in meters.
 to delineate lanes shall be from 8 m up to a maximum of 3 white lines.

Regulatory signs in multi message frames will always be located nearest to the traffic.

All side roads shall be signed appropriately

"END ROAD WORK" plates will be accompanied by plates returning traffic to the original posted speed if a speed reduction has been implemented.

Conflicting signs shall be covered.

Locations of signs and devices may be varied to ensure maximum visibility and safety.

The value of dimension "D" on arterial roads shall be determined as 10% of the speed limit of last the preceding speed zone which is at least 200 m long, expressed in meters.

Value of Dimension D on local roads	
Speed of traffic	Distance in meters
45 or less	0 to 5
46 to 55	15
56 to 65	45
greater than 65	= speed in km/h

Lateral Clearance Requirements.	
Distance to traffic	Maximum Traffic Speed
1.2m to 3m	40 km/h
3m to 6m	60 km/h
6m to 9m	80km/h
above 9m	100km/h

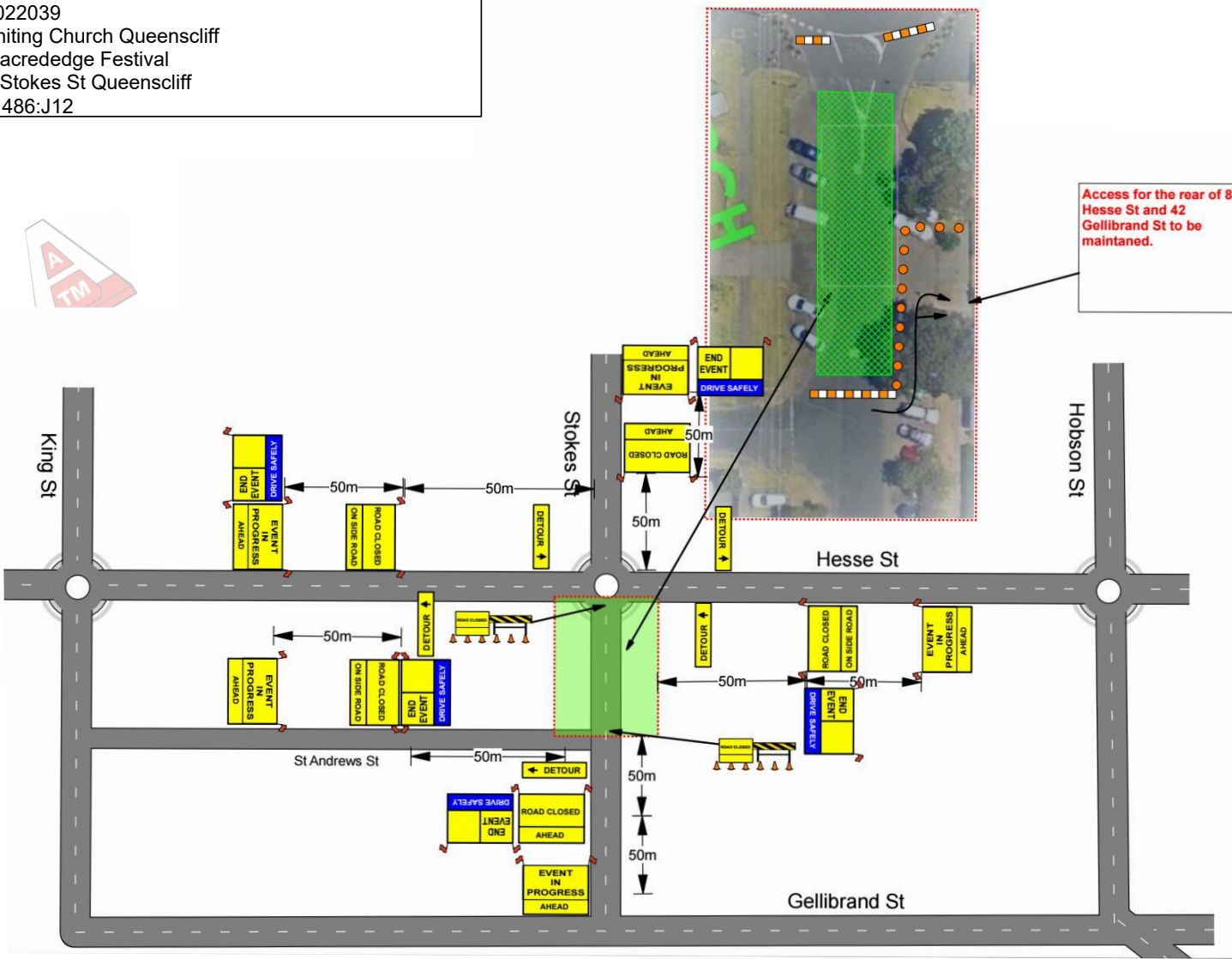

Author: Hamish Wyllie Date: 1/03/2022
 This TMP has been prepared to comply with the AS 1742.3, 2009 and the RMA 2004. It is intended for use solely as a guide for Traffic Management purposes only and is not to scale. All About Traffic Management does not accept any responsibility for compliance of this plan when implemented, amended or monitored by anyone not employed by All About Traffic Management. A review of the traffic control treatments indicated on this TMP should be undertaken by a suitably qualified person prior to, immediately after and at regular intervals during its implementation, to ensure that the treatments used are appropriate to the conditions on site. Any amendments to this TMP, shall be noted on the TMP, recorded on the appropriate worksite paperwork and signed off by the site supervisor prior to implementation.